

Big Bore LT

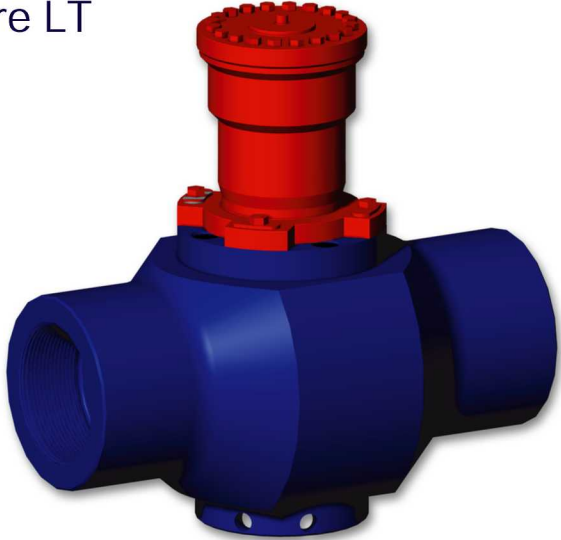

BIG BORE LT

Big Bore LT

MSI offers quality solutions for the oil and gas industry. One of the many ways we do that is with our line of Big Bore Plug Valves. Our extensive line of 2.5", 3", 4" and 5" bore valves provides a true advantage in many applications. The larger bore allows larger tools to be worked through, larger volumes to be pumped and larger volumes to be flowed back with less equipment on location and decreased abrasive erosion.

Our Big Bore Plug Valves offer:

- Durability
- Reliability
- Widest range of end connections in the industry
 - Hammer Union (602, 1002, 1502, 2202)
 - Line Pipe
 - API Flanged
 - Clamp Hub (B20 & others)
 - WingSeal®
 - Tool joint
 - API Flanged x Union
 - Other custom connections and lengths
- Consistency
- Compact design
- Quality

Our Big Bore Plug Valves are operated daily in some of the most severe environments the industry has to offer; for example, Well Head Protection, Frac Stacks, Frac Manifold Trailers, Gravel Pack Manifolds, Flow Back applications and many other well stimulation, flow control and flow back applications.

Bigger and Better



MSI is a division of Dixie Iron Works, Ltd.
 300 West Main St, Alice, Texas 78332
 ph: 800-242-0059 fax: 361-664-4840
 www.diwmsi.com

Big Bore LT

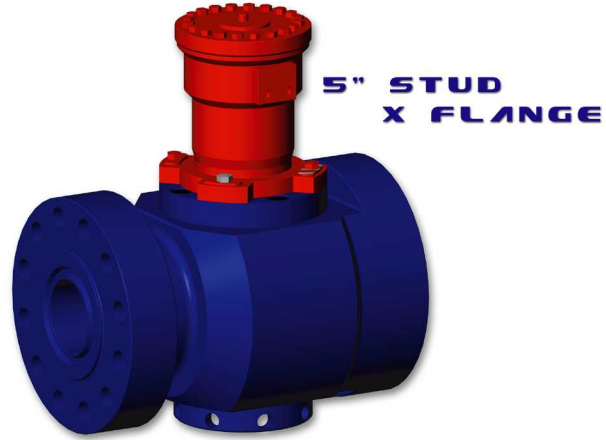

5" STUD
X FLANGE



4" UNION



3" FLANGED

Big Bore 5" LT Cut Away

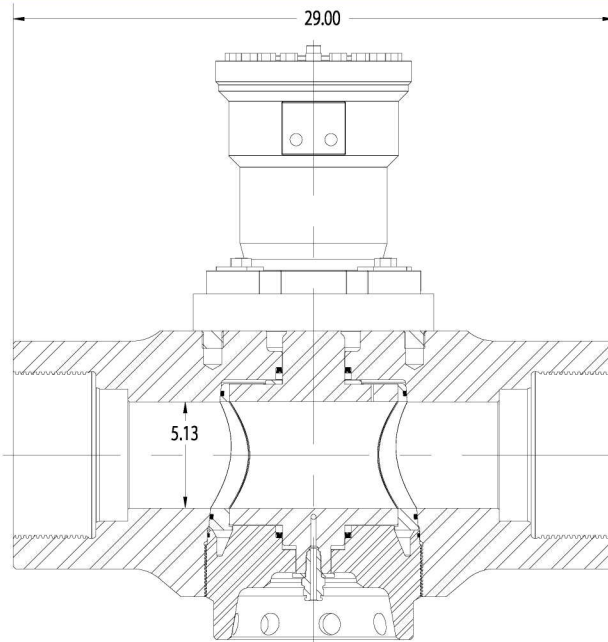

represented by

