



patent pending



UNIsert

MSI UNIsert

MSI's continuing quest for constant improvement of the quality and performance of our products has led to the development of an innovative newly engineered plug valve insert.

We are proud to introduce the new, patent pending one-piece "UNIsert" design.

MSI's UNIsert offers the following key features:

- Lowers the operating torque.
- Eliminates occurrence of pressure-locking (Under certain conditions, such as a rapid pressure drop or a dry gas environment, traditional two-piece inserts can sometimes clamp on the plug and produce higher operating torque.)
- Less chance of damage to the I.D. during shipping, assembly, etc.
- Better grease distribution to the internals
- Positive seating adjusting nut, eliminating over-tightening
- Easier to assemble

The UNIsert has been field tested in some of the most severe environments in the industry, including dry gas, high temperatures, and high working pressures for extended periods of time. Under these conditions the one-piece UNIsert exceeded performance expectations.

Innovation and quality are a part of every MSI product. With the introduction of the MSI UNIsert the tradition continues.

*UNIsert - the single choice in the Industry*

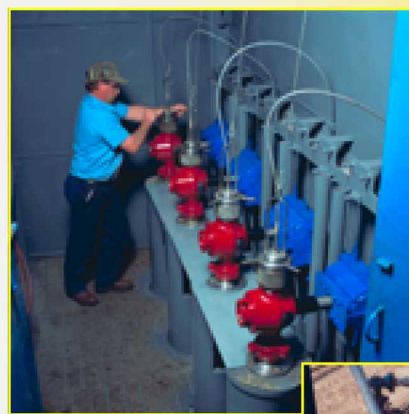

**MSI is a division of Dixie Iron Works, Ltd.**  
 300 West Main St, Alice, Texas 78332  
 ph: 800-242-0059 fax: 361-664-4840  
 www.diwmsi.com

# UNIsert

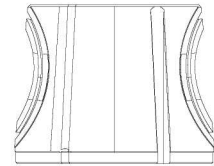
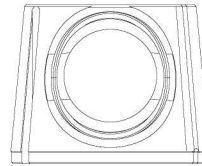
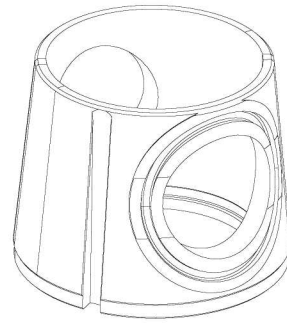
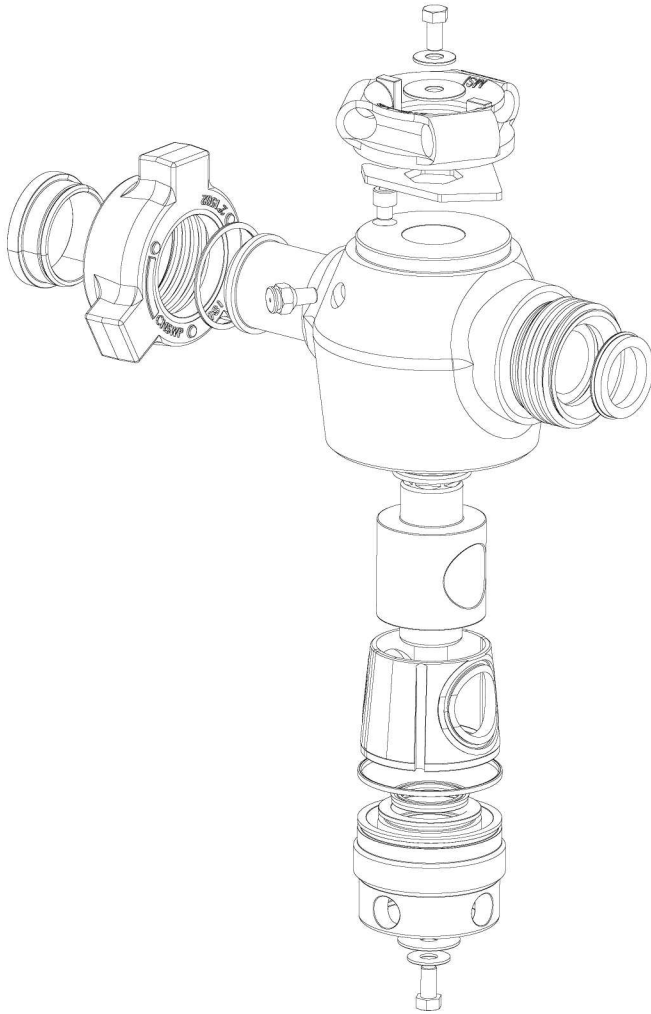

patent pending

The MSI UNIsert will soon be available in the following sizes:

- 2" Standard and H2S sour service
- 2.5" Standard and H2S sour service
- 3" Standard and H2S sour service
- 4" Standard and H2S sour service

We are currently making the changes in our manufacturing and quality system in order to make the UNIsert our default inserts in all valves and repair parts in the sizes offered.

Please contact us for more information on the MSI UNIsert.

(There was no significant performance improvement in the smaller bore valves, thus, they are not offered)

represented by

