

A3

ITEM NO.	QTY.	PART NUMBER	DESCRIPTION
1	1	CC0058	CHOKE CAP, 3" H2S 15M HAMMER (W/RET GROOVE)
2	1	CC0138	MASTER BEAN, ADAPTER H-2
3	1	CC0211	CHOKE BODY, 3"1502FM H2S 10M 2"MAX
4	1	OC0023	O-RING, 3" BONNET H2S
5	1	OC0024	PAR-BACK, 3" BONNET H2S
6	2	UC0005	WINGNUT, 3"1502 H2S
7	1	UC0006	NUT RETAINER SET, 3"1502
8	1	UC0014	RESILIENT SEAL, 3"1502 H2S (HNBR)
9	2	UC0015	SPIRAL RETAINER RING, 3"1502

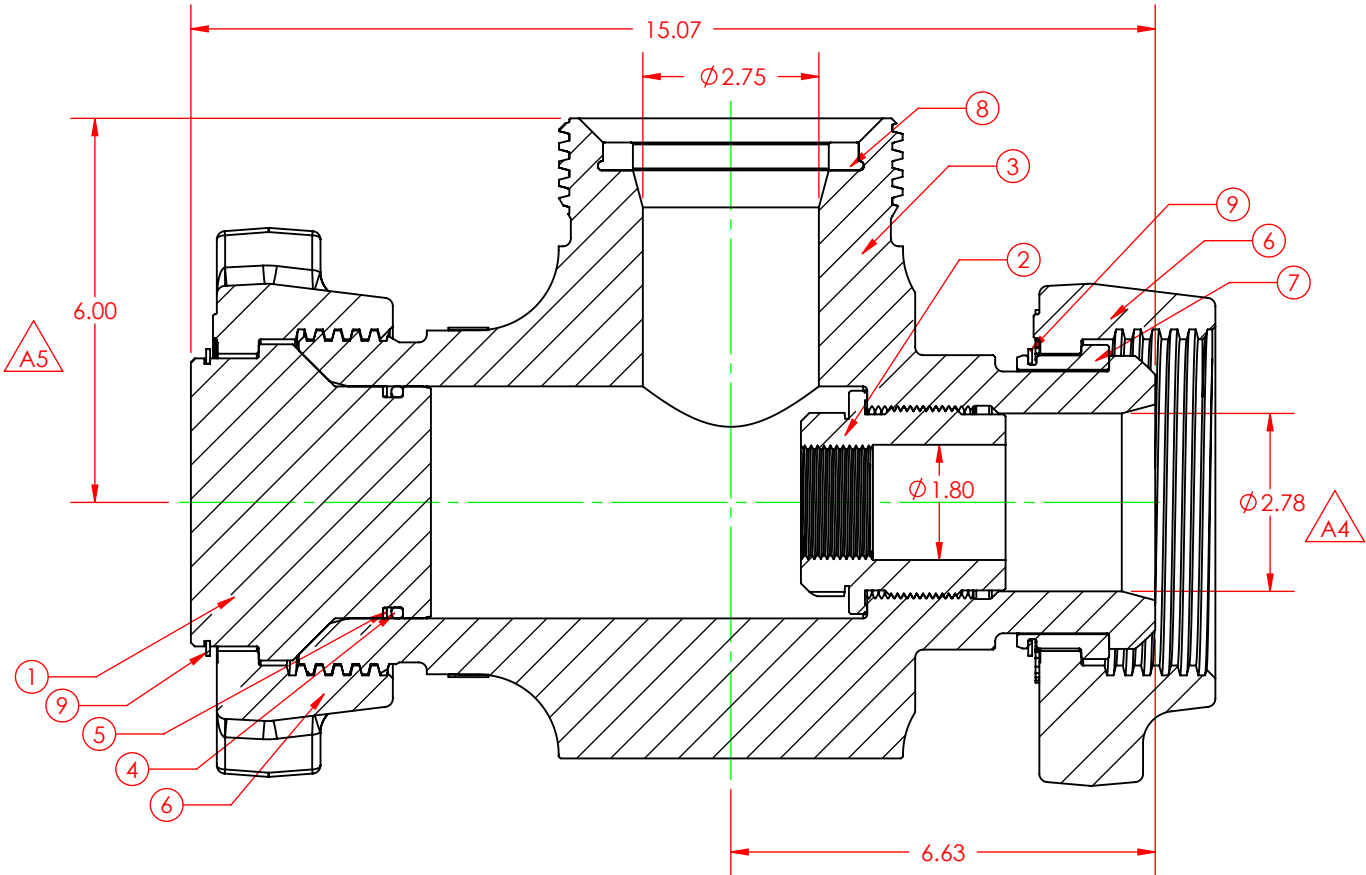

A5

A4

A1

A2

ECN NUMBER 4110	DESCRIPTION POS CHOKE, 3"1502FM H2S 10M
WORKING PRESSURE: 10,000 PSI	TEMPERATURE CLASS: LU
RETAINED FLUIDS: EE-0.5	PR LEVEL: 1
WEIGHT 115 lbs.	SHEET SHEET 1 OF 1
DATE 7/29/05	PART NUMBER CA0036
DRAWN BY HAHII	REV A

CHANGE MADE
 1) REDRAWN IN SOLIDWORKS
 2) UPDATED DESCRIPTION
 3) UPDATED BOM
 4) DIM WAS 2.88; NOW 2.78
 5) REMOVED 9.56 REFER AND ADDED 6.00 TO CENTER
 02/18/11 RSE

MSI
 300 West Main Street
 Alice, TX 78332
 www.djwmsi.com
 800.242.0059
MSI is a division of Dixie Iron Works, Ltd.