

ITEM NO.	QTY.	PART NUMBER	DESCRIPTION
1	1	CC0013	CHOKE INDICATOR, 3/4" (FOR 2" CHOKE)
2	1	CC0014	HANDWHEEL, 2" ADJ CHOKE "MSI"
3	1	CC0016	BONNET, 2" H2S 15M MSI MANUAL
4	1	CC0022	CHOKE STEM, 3/4"-1" MAX 15M LONG
5	1	CC0028	CHOKE PACKING, 2"
6	1	CC0029	CHOKE STEM GUIDE, 2" CHOKE
7	1	CC0030	CHOKE PACKING RETAINER, 2" CHOKE
8	1	CC0044	SNAP RING, 2" CHOKE BONNET
9	1	CC0278	BONNET EXTENSION, 2" MSI MANUAL
10	1	CC0281	BONNET THREAD BUSHING, 2" CHOKE
11	1	HC0012	HEX NUT, 5/8"-11 HEAVY HEX 2H
12	1	HC0013	THUMB SCREW, 3/8"-16 x 1.50" (NYLON TIPPED)
13	1	HC0014	FLAT WASHER, 5/8" STD
14	2	HC0111	LOCK WASHER, 1/4" HIGH COLLAR
15	2	HC0176	SOC HD, 1/4"-20 x 2.25"
16	1	HC0177	BALL, 5/16" BRASS CDA270 GRADE 200
17	1	HC0199	GREASE FITTING, 1/4"NPT ALEMITE
18	1	UC0131	WINGNUT, 2"1502 H2S (10lbs)

A4

A1

A3

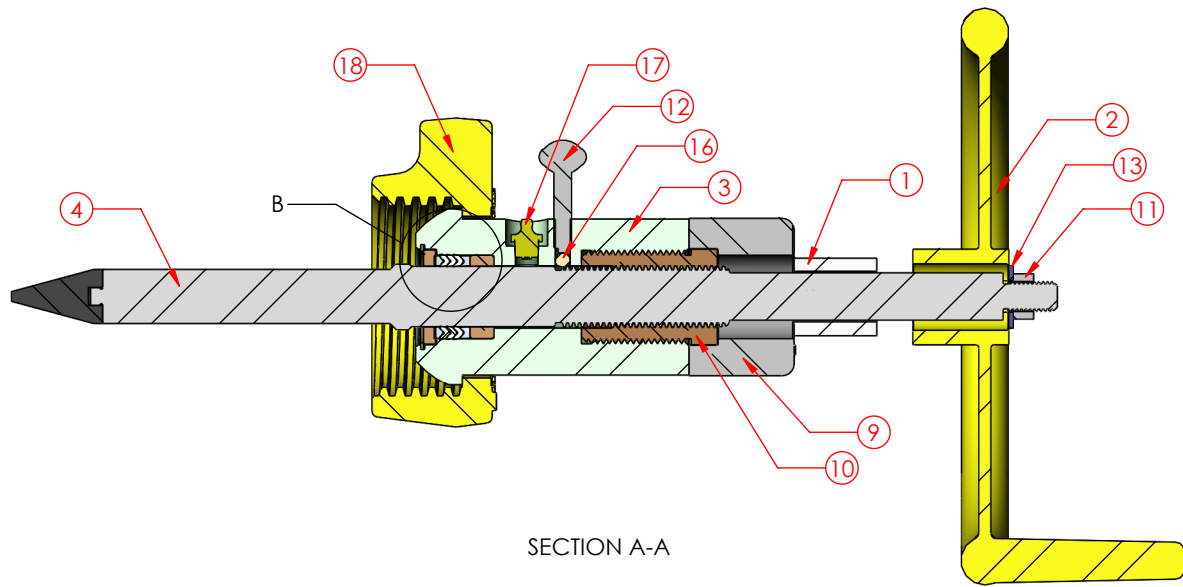
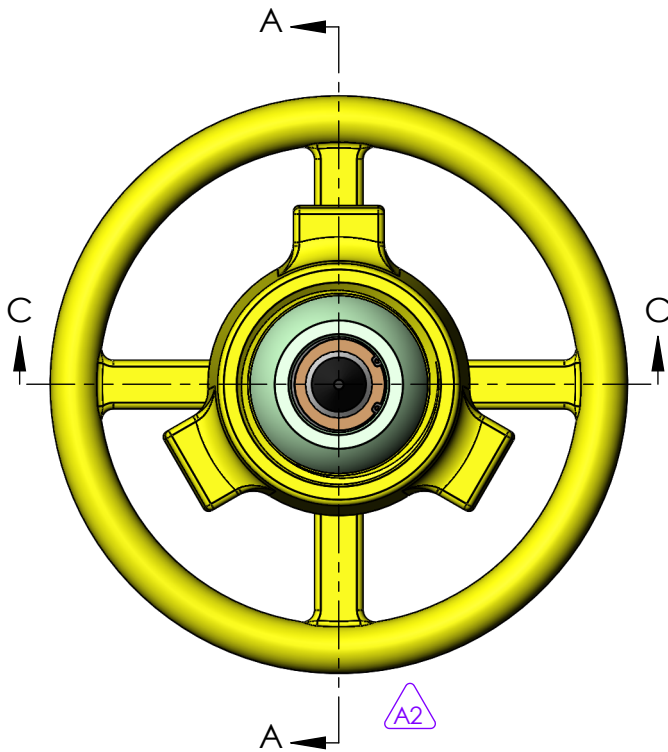

SECTION A-A

A2

A6

CHANGE MADE	REVISED BY	RSE	DATE	05/27/2014
1) REMOVED BANDING ID TAG 2) ADDED PARENT VIEW 3) WINGNUT WAS UC0002; NOW UC0131 4) ADDED HC0111 TO BOM 5) UPDATED DESCRIPTION 6) UPDATED DRAWING TEMPLATE 7) ADDED SHEET TWO FOR DETAIL VIEWS 8)				

ECH NUMBER		DESCRIPTION	
5098		BONNET ASSY, 2" H2S 15M MSI-LONG STEM 3/4" MAX	
WORKING PRESSURE:	TEMPERATURE CLASS:	DRAWN BY:	
15,000 PSI	LU	HAHII	
RETAINED FLUIDS:	PR LEVEL:	DATE:	
EE-0.5	1	9/9/03	
WEIGHT:	SHEET:	PART NUMBER:	REV:
41 LBS.	SHEET 1 OF 2	CA0040	A

300 WEST MAIN ST.  
ALICE, TX 78332  
www.diwmsi.com  
800.242.0059  
MSI IS A DIVISION OF DIXIE IRON WORKS, LTD.

THIS DRAWING IS THE PROPERTY OF DIXIE IRON WORKS, LTD. THE BORROWER AGREES BY RECEIVING THE DRAWING TO RETURN IT UPON REQUEST AND TO NEITHER REPRODUCE COPY OR FURNISH INFORMATION FROM IT TO OTHERS WITHOUT EXPRESSED WRITTEN PERMISSION OF DIXIE IRON WORKS, LTD. ALL ARTICLES MANUFACTURED IN ACCORDANCE WITH THIS DRAWING SHALL BE CONSIDERED DESIGNS OF DIXIE IRON WORKS, LTD. AND MAY NOT BE USED OR SOLD WITHOUT DIXIE IRON WORKS, LTD. WRITTEN PERMISSION.

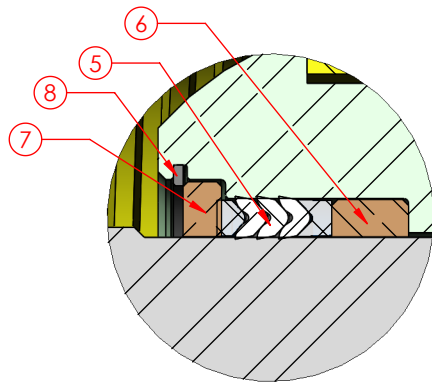

DETAIL B  
PACKING ORIENTATION

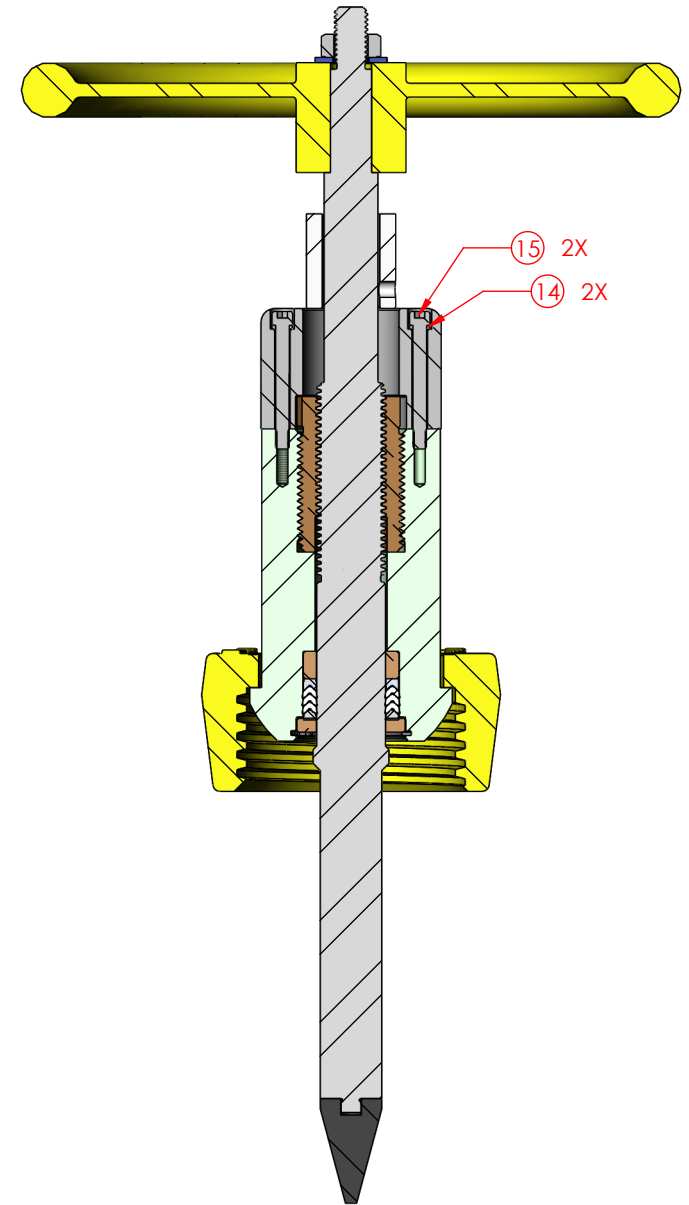

SECTION C-C



300 WEST MAIN ST.  
ALICE, TX 78332

www.diwmsi.com  
800.242.0059

MSI IS A DIVISION OF DIXIE IRON WORKS, LTD.

ECH NUMBER	DESCRIPTION
5098	BONNET ASSY, 2" H2S 15M MSI-LONG STEM 3/4" MAX

CHANGE MADE	REVISED BY	DATE
1) REMOVED BANDING ID TAG	RSE	05/27/2014
2) ADDED PARENT VIEW		
3) WINGNUT WAS UC0002; NOW UC0131		
4) ADDED HC0111 TO BOM		
5) UPDATED DESCRIPTION		
6) UPDATED DRAWING TEMPLATE		
7) ADDED SHEET TWO FOR DETAIL VIEWS		
8)		

WORKING PRESSURE:	TEMPERATURE CLASS:	DRAWN BY:
15,000 PSI	LU	HAHII
RETAINED FLUIDS:	PR LEVEL:	DATE:
EE-0.5	1	9/9/03
WEIGHT:	SHEET:	PART NUMBER:
41 LBS.	SHEET 2 OF 2	CA0040

REV. A