

ITEM NO.	QTY.	PART NUMBER	DESCRIPTION
1	1	CC0006	BONNET, 3" H2S 15M H-2 (HAMMER)
2	1	CC0008	HANDWHEEL, 3" ADJ CHOKE H2-2"MAX
3	1	CC0027	CHOKE PACKING, H2 COMPLETE (2"MAX)
4	1	CC0034	CHOKE INDICATOR, 2"MAX H2 (FOR 3"CHOKE)
5	1	CC0059	CHOKE STEM, 2"MAX TUNGSTEN CARBIDE H-2
6	1	CC0285	BONNET THREAD BUSHING, 3" CHOKE
7	1	CC0286	BONNET EXTENSION, 3" MSI MANUAL
8	1	HC0012	HEX NUT, 5/8"-11 HEAVY HEX 2H
9	1	HC0013	THUMB SCREW, 3/8"-16 x 1.50" (NYLON TIPPED)
10	1	HC0014	FLAT WASHER, 5/8" STD
11	2	HC0111	LOCK WASHER, 1/4" HIGH COLLAR
12	1	HC0177	BALL, 5/16" BRASS CDA270 GRADE 200
13	2	HC0203	SOC HD, 1/4"-20 x 1.50"
14	1	HC0209	LOCK WASHER, 5/8" STANDARD
15	1	HC0517	GREASE FITTING, 1/8" NPT ALEMITE
16	1	OC0023	O-RING, 3" BONNET H2S (2-339)
17	1	OC0024	PAR-BACK, 3" BONNET H2S (8-339)
18	1	UC0005	WINGNUT, 3" 1502 H2S

A2  
A3

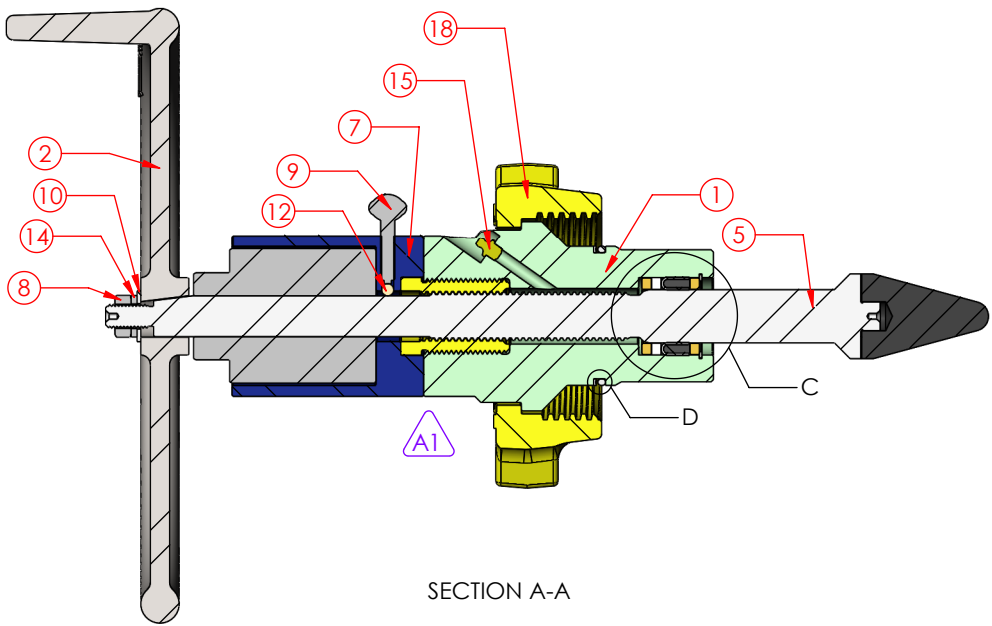

A1

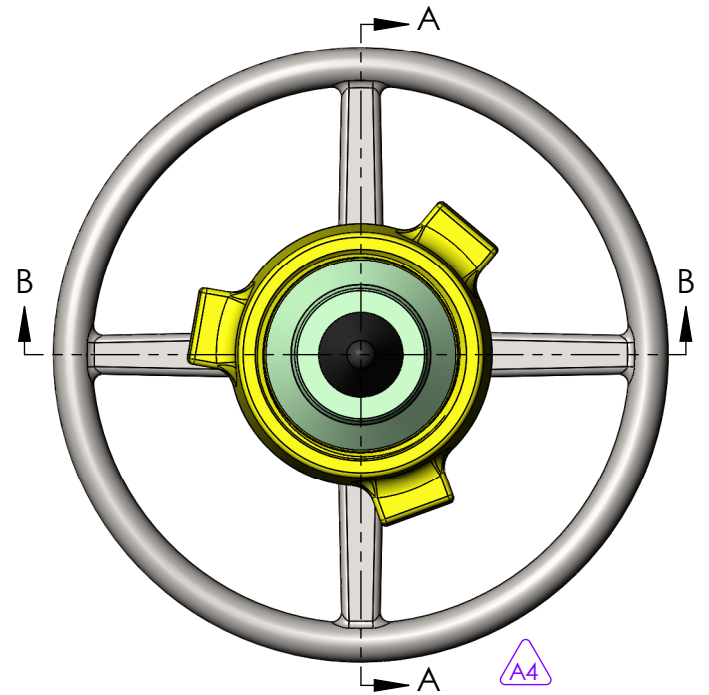

A4

A5

CHANGE MADE		REVISED BY	LMS	DATE	4/30/2015
1) UPDATED CC0006 WITH GREASE FITTING HOLE					
2) ADDED HC0517 AND HC0209 TO BOM					
3) REMOVED BANDING TAG					
4) ADDED PARENT VIEW					
5) UPDATED SHEET TEMPLATE					
6) ADDED PAGE 2					
7)					
8)					
ECN NUMBER	5433				
DESCRIPTION	BONNET ASSY, 3" H2S 15M H-2 (HAMMER)				
WORKING PRESSURE:	TEMPERATURE CLASS:	DRAWN BY:			
15,0000 PSI	LU	RMR			
RETAINED FLUIDS:	PR LEVEL:	DATE:			
EE-0.5	1	04/11/2008			
WEIGHT:	SHEET:	PART NUMBER:		REV:	
71 lbs.	SHEET 1 OF 2	CA0065		A	



THIS DRAWING IS THE PROPERTY OF DIXIE IRON WORKS, LTD. THE BORROWER AGREES BY RECEIVING THE DRAWING TO RETURN IT UPON REQUEST AND TO NEITHER REPRODUCE COPY OR FURNISH INFORMATION FROM IT TO OTHERS WITHOUT EXPRESSED WRITTEN PERMISSION OF DIXIE IRON WORKS, LTD. ALL ARTICLES MANUFACTURED IN ACCORDANCE WITH THIS DRAWING SHALL BE CONSIDERED DESIGNS OF DIXIE IRON WORKS, LTD. AND MAY NOT BE USED OR SOLD WITHOUT DIXIE IRON WORKS, LTD. WRITTEN PERMISSION.

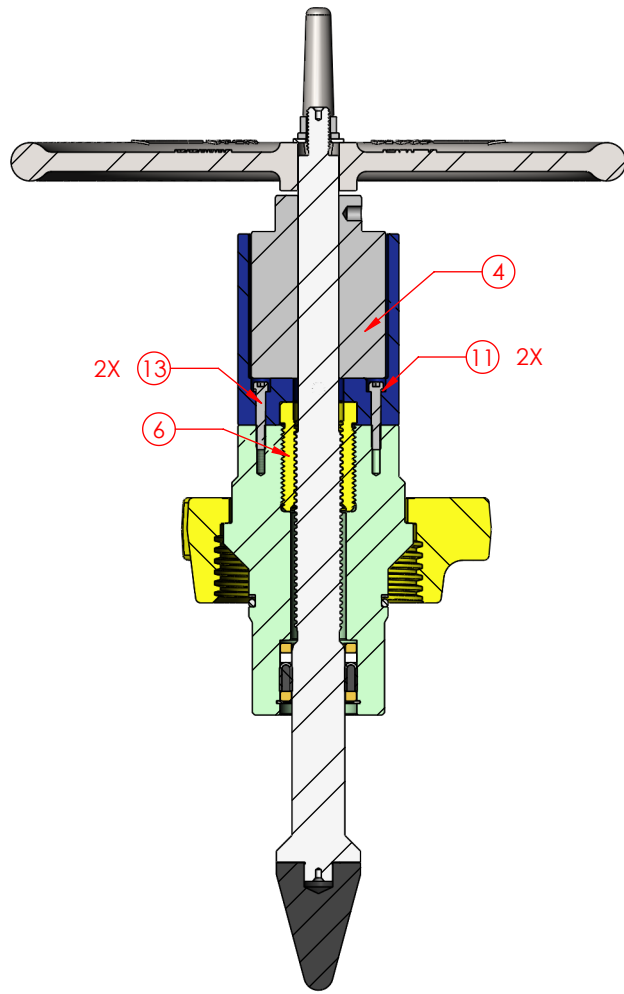

SECTION B-B

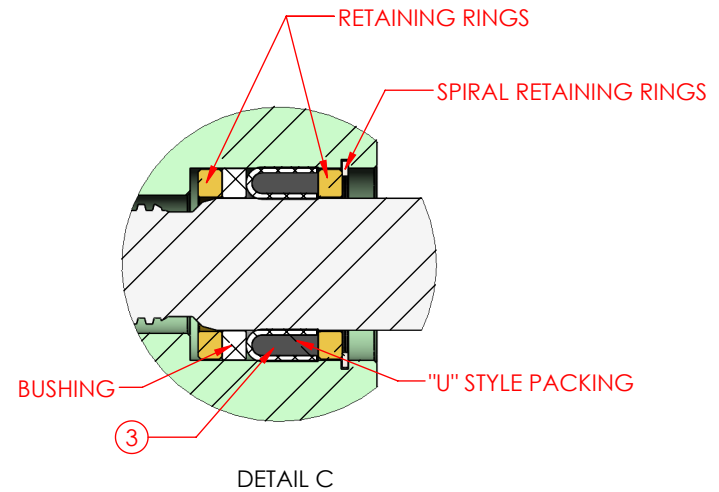

DETAIL C

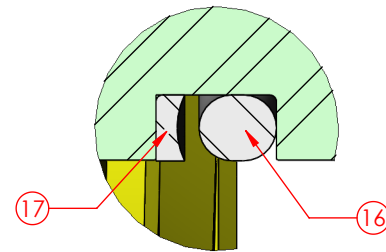

DETAIL D

CHANGE MADE	REVISED BY	DATE
1) UPDATED CC0006 WITH GREASE FITTING HOLE	LMS	4/30/2015
2) ADDED HC0517 AND HC0209 TO BOM		
3) REMOVED BANDING TAG		
4) ADDED PARENT VIEW		
5) UPDATED SHEET TEMPLATE		
6) ADDED PAGE 2		
7)		
8)		

ECN NUMBER	DESCRIPTION		
5433	BONNET ASSY, 3" H2S 15M H-2 (HAMMER)		
WORKING PRESSURE:	TEMPERATURE CLASS:	DRAWN BY:	
15,0000 PSI	LU	RMR	
RETAINED FLUIDS:	PR LEVEL:	DATE:	
EE-0.5	1	04/11/2008	
WEIGHT:	SHEET:	PART NUMBER:	
71 lbs.	SHEET 2 OF 2	CA0065	



300 WEST MAIN ST.  
ALICE, TX 78332  
www.diwmsi.com  
800.242.0059

MSI IS A DIVISION OF DIXIE IRON WORKS, LTD.

THIS DRAWING IS THE PROPERTY OF DIXIE IRON WORKS, LTD. THE BORROWER AGREES BY RECEIVING THE DRAWING TO RETURN IT UPON REQUEST AND TO NEITHER REPRODUCE COPY OR FURNISH INFORMATION FROM IT TO OTHERS WITHOUT EXPRESSED WRITTEN PERMISSION OF DIXIE IRON WORKS, LTD. ALL ARTICLES MANUFACTURED IN ACCORDANCE WITH THIS DRAWING SHALL BE CONSIDERED DESIGNS OF DIXIE IRON WORKS, LTD. AND MAY NOT BE USED OR SOLD WITHOUT DIXIE IRON WORKS, LTD. WRITTEN PERMISSION.