

1 2 3 4 5 6 7 8

A

B

C

D

E

F

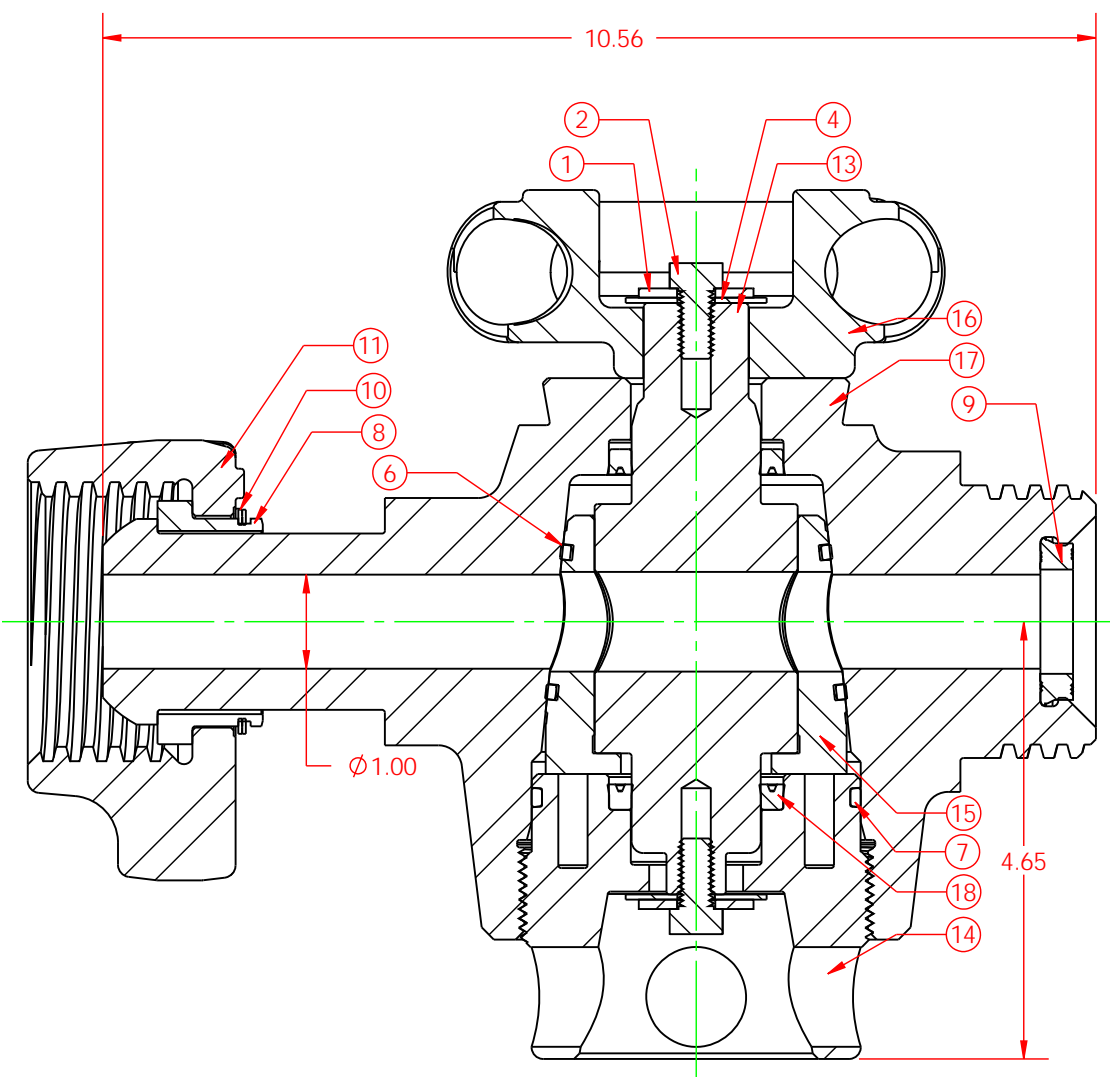

ITEM NO.	QTY.	PART NUMBER	DESCRIPTION
1	2	HC0002	FLAT WASHER, 3/8" STD
2	2	HC0004	HEX HD, 3/8"-16 x 0.75"
3	1	HC0005	SOC HD, 3/8"-16 x 0.50"
4	2	HC0027	FLAT WASHER, 3/8" OVERSIZED
5	1	HC0226	GREASE FITTING, 3/4" SAFETAP H2S GBH
6	2	OC0013	O-RING, 1" INSERT H2S
7	1	OC0017	O-RING, 1" ADJ NUT H2S
8	1	UC0136	NUT RETAINER SET, 1"1502
9	1	UC0230	RESILIENT SEAL, 1" UNION H2S (HSN)
10	1	UC0277	SPIRAL RETAINER RING, 1" 1502
11	1	UC0410	WINGNUT, 1"1502 H2S
12	1	VC0013	NAME TAG - VALVE(MSI/DIXIE)
13	1	VC0030	PLUG, 1" H2S
14	1	VC0038	ADJUSTING NUT, 1" H2S
15	1	VC0048	INSERT SET, 1" H2S
16	1	VC0063	HANDLE ADAPTER, 1" PLUG VALVE
17	1	VC0111	VLV BODY, 1" x 1"1502 H2S 10M
18	2	VC0112	PLUG SEAL, 1" H2S (HSN/BRASS)

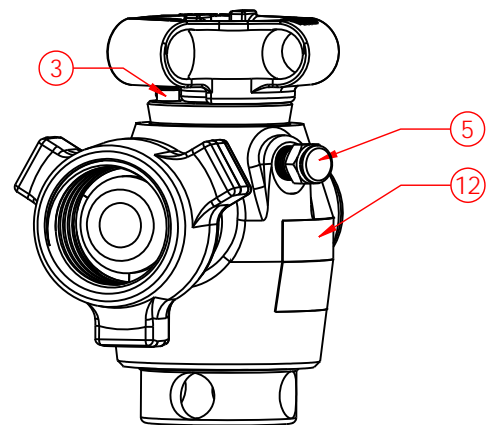

G

THIS DRAWING IS THE PROPERTY OF DIXIE IRON WORKS, LTD. THE BORROWER AGREES BY RECEIVING THE DRAWING TO RETURN IT UPON REQUEST AND TO NEITHER REPRODUCE COPY OR FURNISH INFORMATION FROM IT TO OTHERS WITHOUT EXPRESSED WRITTEN PERMISSION OF DIXIE IRON WORKS, LTD. ALL ARTICLES MANUFACTURED IN ACCORDANCE WITH THIS DRAWING SHALL BE CONSIDERED DESIGNS OF DIXIE IRON WORKS, LTD. AND MAY NOT BE USED OR SOLD WITHOUT DIXIE IRON WORKS, LTD. WRITTEN PERMISSION.

NOTES
 1. BREAK ALL EDGES 0.008/0.016 x 45° OR R0.008/0.016 EXCEPT THREADS.
 2. ALL MACHINED CORNER RADII TO BE R0.025.
 3. ALL DIMENSIONS ARE IN INCHES (UNLESS OTHERWISE STATED).
 4. BLUNT START ALL ACME THREADS.
 5. ALL DIAMETERS TO BE CONCENTRIC WITHIN 0.005" (UNLESS OTHERWISE STATED).
 6. MACHINED SURFACES TO BE 325µm Ra (UNLESS OTHERWISE STATED).
 7. ALL DIMENSIONS IN PARENTHESIS ARE REFERENCE DIMENSIONS (±0.005).
 8. "C" DENOTES SYMMETRY BETWEEN FEATURES, ABOUT "C" AXIS, UNLESS NOTED OTHERWISE.

THIRD ANGLE PROJECTION

UNSPECIFIED TOLERANCES	REVISION	CHANGE MADE	ECN NUMBER	DESCRIPTION
FRACTIONS ±1/64 DECIMALS .XX ±0.010 XXX ±0.005 XXXX ±0.001 ANGLE ±1/2°	0			VALVE, 1" x 1"1502 H2S 10M
DATUM INDICATING SYMBOL	CONCENTRICITY	ANGULARITY	RUNOUT	COUNTERBORE
POSITION	FLATNESS	PERPENDICULARITY	PARALLELISM	COUNTERSINK

DESCRIPTION	DRAWN BY	DATE	PART NUMBER	REV
VALVE, 1" x 1"1502 H2S 10M	HP	02/27/2007	VA0154	0
MATERIAL/HEAT TREAT/ WELD PROCEDURE SOUR SERVICE 10,000 WORKING PRESSURE				
WEIGHT 41 lbs.	SHEET SHEET 1 OF 1			

300 West Main Street
Alice, TX 78332
www.dlwmsi.com
800.242.0059
MSI is a division of Dixie Iron Works, Ltd.