

1

2

3

4

5

6

7

8

ITEM  
NO.

QTY.

PART NUMBER

DESCRIPTION

1

1

VC0279

VALVE BODY, 2.5" x 3.5" IF B/P STD

2

1

VC0019

INSERT SET, 2.5" STD UNISERT

3

1

VC0021

PLUG, 2.5" STD

4

1

VC0020

ADJUSTING NUT, 2.5" H2S

5

2

VC0060

PLUG SEAL, 2" STD (BUNA/BRASS)

6

2

OC0021

O-RING, 2.5" INSERT STD

7

1

OC0022

O-RING, 2.5" ADJ NUT STD

8

2

HC0006

FLAT WASHER, 1/2" STD

9

2

HC0007

FLAT WASHER, 1/2" OVERSIZED

10

2

HC0009

HEX HD, 1/2"-20 x 1.00"

11

1

HC0008

SOC HD, 1/2"-13 x 0.50"

12

1

VC0061

STOP COLLAR, 2", 3", 4"

13

1

VC0062

HANDLE ADAPTER, 2", 3", 4"

14

1

HC0226

GREASE FITTING, 3/4" SAFETAP H2S GBH

15

1

VC0013

NAME TAG- VALVE (MSI/DIXIE)

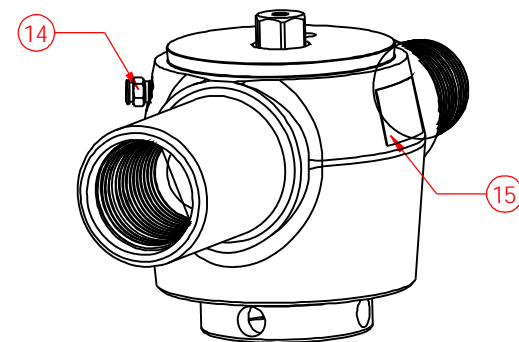
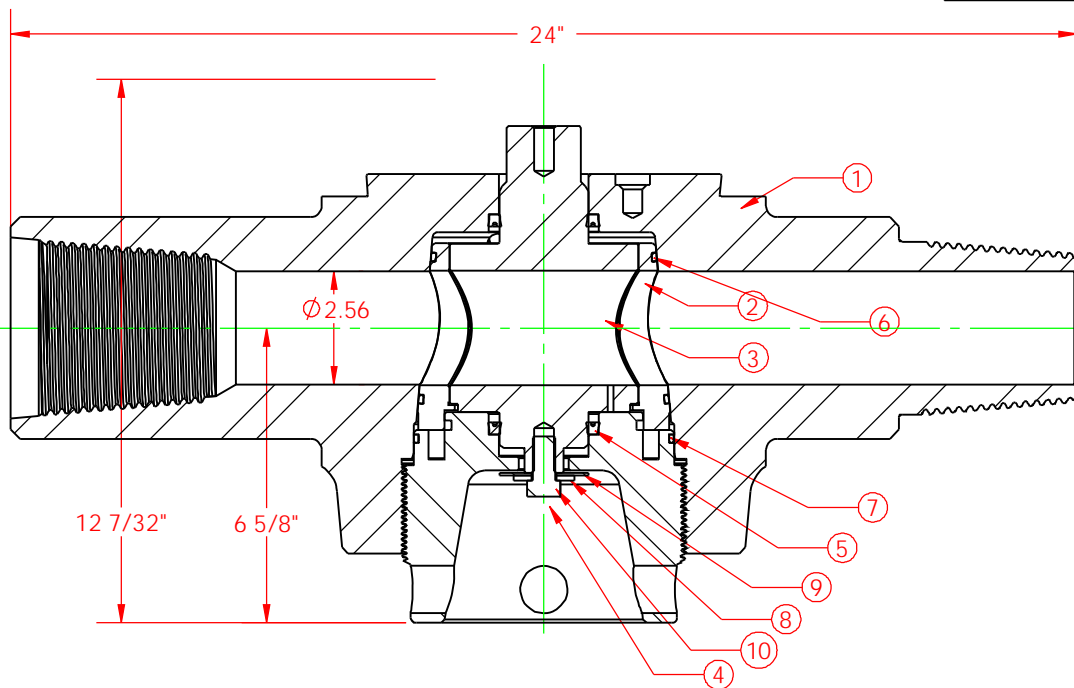

THIS DRAWING IS THE PROPERTY OF DIXIE IRON WORKS, LTD. THE BORROWER AGREES BY RECEIVING THE DRAWING TO RETURN IT UPON REQUEST AND TO NEITHER REPRODUCE COPY OR FURNISH INFORMATION FROM IT TO OTHERS WITHOUT EXPRESSED WRITTEN PERMISSION OF DIXIE IRON WORKS, LTD. ALL ARTICLES MANUFACTURED IN ACCORDANCE WITH THIS DRAWING SHALL BE CONSIDERED DESIGNS OF DIXIE IRON WORKS, LTD. AND MAY NOT BE USED OR SOLD WITHOUT DIXIE IRON WORKS, LTD. WRITTEN PERMISSION.

## NOTES

- BREAK ALL EDGES 0.008/0.016 x 45° OR R0.008/0.016 EXCEPT THREADS.
- ALL MACHINED CORNERS R0.031.
- ALL DIMENSIONS ARE IN INCHES (UNLESS OTHERWISE STATED).
- BLIND START ALL HOLES, THREADS.
- ALL DIA'S ARE TO BE CONCENTRIC WITH DIA'S (UNLESS OTHERWISE STATED).
- MACHINED SURFACES TO BE 125µ Ra (UNLESS OTHERWISE STATED).
- ALL DIMENSIONS IN PARENTHESES ARE REFERENCE DIMENSIONS (X.XXX).

THIRD ANGLE PROJECTION



## UNSPECIFIED TOLERANCES

FRACTIONS ±1/64  
DECIMALS .XX ±0.015  
XXX ±0.025  
XXXX ±0.051

ANGLE ±1/2°

## REVISION

0

## CHANGE MADE

## ECN NUMBER

## DESCRIPTION

VALVE,  
2.5" x 3.5" IF B/P STD 10M

MATERIAL/ HEAT TREAT/ WELD PROCEDURE  
STANDARD SERVICE  
10,000 PSI WORKING PRESSURE

WEIGHT 192.93 LBS

SHEET 1 OF 1

DRAWN BY  
WJTDATE  
07/18/03PART NUMBER  
VA0264

COMPUTER GENERATED BY

300 West Main Street  
Alice, Texas 78332REV  
0