

NOTE:
PLEASE REFER TO OA0015 FOR HARDNESS STENCILING PER API.

ITEM NO.	QTY.	PART NUMBER	DESCRIPTION
1	1	AA0019	ACTUATOR, ELOMATIC ESA-950 (FAIL-SAFE)
2	2	HC0003	ROLL PIN, 5/16" X 3/4" (LARGE)
3	1	HC0006	FLAT WASHER, 1/2" STD
4	1	HC0007	FLAT WASHER, 1/2" FENDER (2"OD)
5	1	HC0009	HEX HD, 1/2"-20 x 1.00"
6	2	HC0011	ROLL PIN, 3/16" X 11/16" (SMALL)
7	4	HC0025	LOCK WASHER, 3/8" HIGH COLLAR
8	4	HC0048	LOCK WASHER, 5/8" HIGH COLLAR
9	4	HC0049	SOC HD, 3/8"-16 x 1.50"
10	4	HC0069	SOC HD, 5/8"-11 x 1.25"
11	1	HC0080	HEX HD, 1/4"-20 x 0.75"
12	1	HC0226-PSL2	GREASE FITTING, 3/4" SAFETAP H2S GBH - PSL2
13	1	HC0386	FLAT WASHER, 1/4" STD
14	1	HC0387	CHAIN, 1/8" GRADE 30 -10"
15	1	HC0392	HEX NUT, 1/4"-20
16	1	HC0396	QUICK RELEASE PIN, 3/4" x 7"
17	2	OC0011	O-RING, 2" INSERT STD (2-230 BUNA 90)
18	1	OC0012	O-RING, 2" ADJ NUT STD (2-245 BUNA 90)
19	1	UC0002-PSL2	WINGNUT, 2"1502 STD PSL2
20	1	UC0003-PSL2	NUT RETAINER SET, 2"1502 PSL2
21	1	UC0004	SPIRAL RETAINER RING, 2"1502
22	1	UC0011	RESILIENT SEAL, 2"1502 STD (BUNA)
23	1	VC0022-PSL2	VLV BODY, 2" x 2"1502 STD 15M PSL2
24	1	VC0024-PSL2	PLUG, 2"STD PSL2
25	1	VC0027S	INSERT SET, 2" STD (SPLIT)
26	1	VC0028-PSL2	ADJUSTING NUT, 2" H2S PSL2
27	2	VC0060	PLUG SEAL, 1.75" - 3" STD (BUNA/BRASS)
28	1	VC0126-1	ACT BRACKET, ELOMATIC 1100 LARGE HEX
29	1	VC0325	ACT ADAPTER, ELOMATIC 1100 LARGE HEX

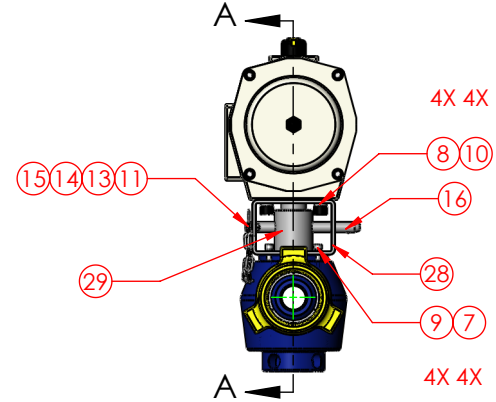
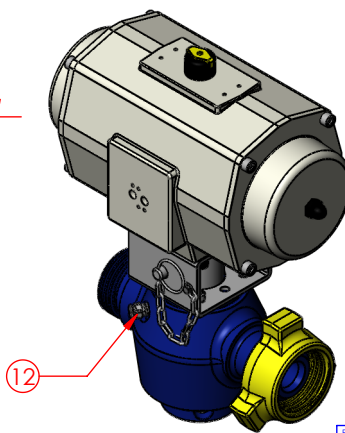
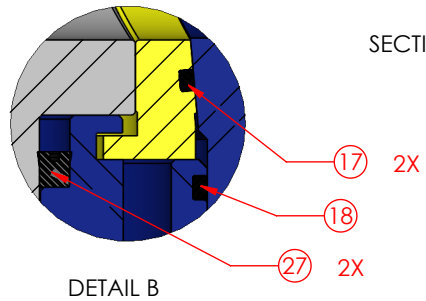
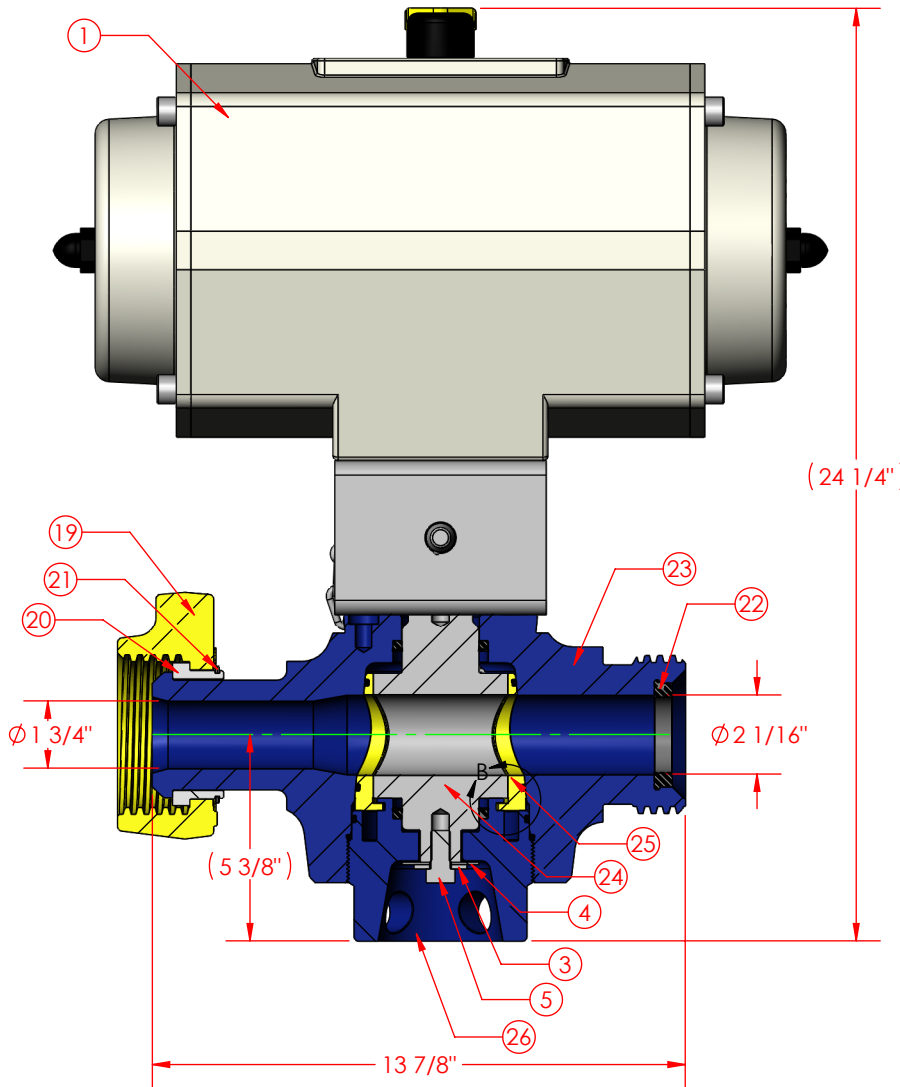

CHANGE MADE	REVISED BY	DATE
1)		
2)		
3)		
4)		
5)		
6)		
7)		
8)		

E/CN NUMBER		DESCRIPTION	
		VALVE, 2" x 2"1502 STD 15M (AIR ACT'D-FS) PSL2 *API6A	
WORKING PRESSURE:	TEMPERATURE CLASS:	DRAWN BY:	
15,000 PSI	PU	RSE	
RETAINED FLUIDS:	PR LEVEL:	DATE:	
AA	1	11/24/2015	
WEIGHT:	SHEET	PART NUMBER	REV
450 lbs.	SHEET 1 OF 1	VA0510-S-API-PSL2	0

300 WEST MAIN ST.
ALICE, TX 78332
www.diwmsi.com
800.242.0059
MSI IS A DIVISION OF DIXIE IRON WORKS, LTD.

THIS DRAWING IS THE PROPERTY OF DIXIE IRON WORKS, LTD. THE BORROWER AGREES BY RECEIVING THE DRAWING TO RETURN IT UPON REQUEST AND TO NEITHER REPRODUCE COPY OR FURNISH INFORMATION FROM IT TO OTHERS WITHOUT EXPRESSED WRITTEN PERMISSION OF DIXIE IRON WORKS, LTD. ALL ARTICLES MANUFACTURED IN ACCORDANCE WITH THIS DRAWING SHALL BE CONSIDERED DESIGNS OF DIXIE IRON WORKS, LTD. AND MAY NOT BE USED OR SOLD WITHOUT DIXIE IRON WORKS, LTD. WRITTEN PERMISSION.